



# BEVERAGE-AIR®

Commercial Refrigeration Equipment  
General Specifications

## WORKTOP COOLERS

Versatile, compact (29" deep) models with stainless steel work tops and refrigerated storage of food products. Working height is 35-1/2".

### Cabinet construction:

Heavy duty construction, #3 finish stainless steel on front, sides, door(s) and grille. Stainless steel 2-1/2" thick work top with 4" high removable backsplash. Exterior back and bottom made from galvanized steel. Interior liner is made of corrosion resistant anodized aluminum. Interior thermometer is standard.

Cabinets are insulated with foamed-in-place polyurethane insulation of 2" minimum thickness. Doors are mounted to cabinet self-closing on cam lift hinges with 120 degree stay open feature. Pull-out drawers (2) on Model WTRD27 will accommodate 12x20 pans by others. Each door or drawer equipped with a snap in place vinyl magnetic gasket for a positive seal. Double pull style door handle made of black anodized aluminum. 6" high casters are standard, 2 include brakes. An 8' cord set is provided with 115 volt models. Cabinet interior standard with two epoxy wire coated shelves per section, adjustable in 1/2 inch increments. Interior light with manual switch is provided with glass door models.

### Refrigeration:

Refrigeration system utilizes R134a refrigerant metered by a capillary tube system. Automatic (non-electric) condensate evaporator is standard. Unique front breathing through grilles located below doors permits unit to be installed against back walls and curbs. Interior forced air system, with high humidity evaporator coils, provides the ideal environment for food preservation.

Item No. \_\_\_\_\_

Quantity \_\_\_\_\_

**29" DEPTH  
WORKTOP  
REFRIGERATOR**  
FOOD PREPARATION SERIES

**MODELS:**  
WTR27  
WTRD27  
WTR48  
WTR60  
WTR72



WTR27



WTRD27



WTR48

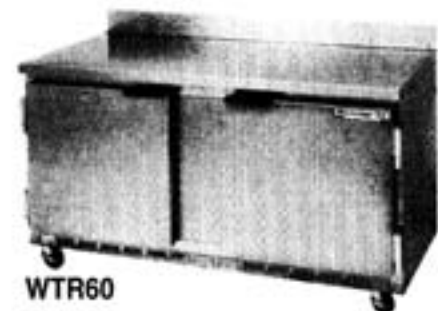

WTR60

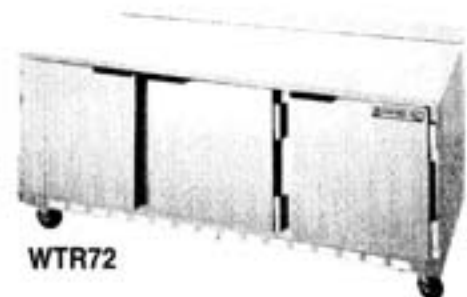

WTR72



Made in USA  
<http://www.Beverage-Air.com>

**BEVERAGE-AIR®**  
a Specialty Equipment company  
PO Box 5932, Spartanburg, SC 29304  
1-800-645-9800 Fax No. 1-854-582-5083

Model Specified \_\_\_\_\_ Store# \_\_\_\_\_

Location \_\_\_\_\_ Quantity \_\_\_\_\_

# BEVERAGE-AIR.

## Standard Worktop Refrigerator Cabinets

Models: WTR27 / WTRD27 / WTR48 / WTR60 / WTR72

MODEL	WTR27	WTR48	WTR60	WTR72
<b>DIMENSIONAL DATA</b>				
Net Capacity (cubic ft.)	6.2	11.8	14.5	17.7
Net Capacity (liters)	175	334	410	501
Length overall (inches)	27"	48"	60"	72"
Length overall (mm)	686	1219	1524	1829
Depth overall (inches) - Less handle	29 1/4"	29 1/4"	29 1/4"	29 1/4"
Depth overall (mm) - Less handle	743	743	743	743
Height overall - on 6" casters (inches)	39 1/2"	39 1/2"	39 1/2"	39 1/2"
Height overall - on 6" casters (mm)	1003	1003	1003	1003
Depth with door open 90° (inches)	53 1/8"	50 1/8"	53 1/8"	50 1/8"
Clear Door Opening (inches)	22 1/2 x 21 1/2	19 1/2 x 21 1/2	22 1/2 x 21 1/2	19 1/2 x 21 1/2
Number of Shelves	2	4	4	6
Number of doors	1	2	2	3
<b>ELECTRICAL DATA</b>				
Full load amperes 115/60/1	4.0	4.5	6.5	6.5
Full load amperes 220/50/1	-	-	-	-
<b>REFRIGERATION DATA</b>				
Refrigerant	R134a	R134a	R134a	R134a
Horsepower	1/6	1/5	1/4	1/4
<b>WEIGHT DATA</b>				
Gross Weight (Crated lbs)	167	242	271	330
Gross Weight (Crated kg)	75	109	123	149

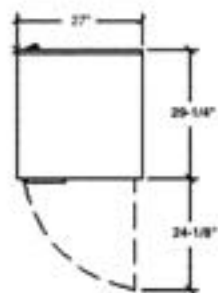

WTR27 Top

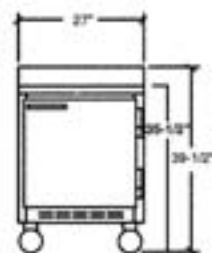

WTR27 Front

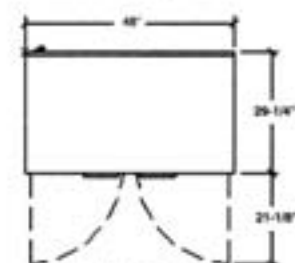

WTR48 Top

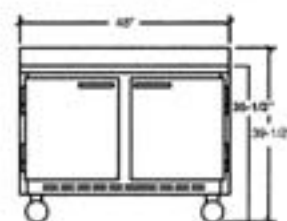

WTR48 Front

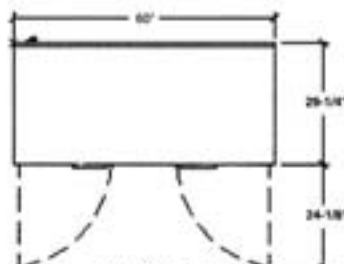

WTR60 Top

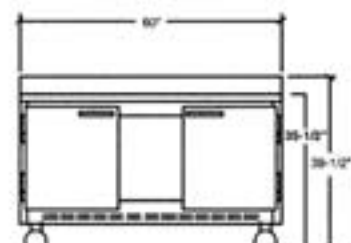

WTR60 Front

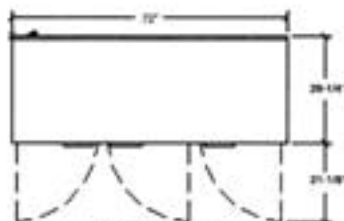

WTR72 Top

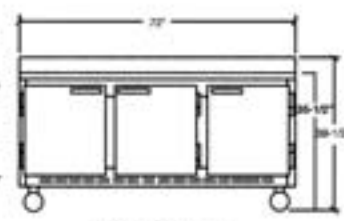

WTR72 Front



Available From:



**BEVERAGE-AIR.**

a Specialty Equipment company

PO Box 5932 • Spartanburg, SC • 29304 • USA  
1-800-845-9800 • Fax No. 1-864-582-5083  
www.Beverage-Air.com