



BEVERAGE-AIR®

Commercial Refrigeration Equipment
General Specifications

Item No. _____

Quantity _____

**29" DEPTH
UNDERCOUNTER
FREEZER**
FOOD PREPARATION SERIES

**MODELS:
UCF27
UCF48**

UCF-SERIES UNDERCOUNTER UNITS

Versatile, compact (29" deep) models for under the counter frozen storage of food products. Height is 34-1/2".

Cabinet Construction

Heavy duty construction includes #3 finish exterior stainless steel on front, sides, door(s) and grille. Cabinet back and bottom are galvanized steel. Interior liner is made of anodized aluminum for longer lasting corrosion protection. Interior thermometer is standard.

Cabinets are insulated with foamed-in-place polyurethane insulation of 2" minimum thickness, except top at 1-1/2". Doors are gravity self-closing mounted to cabinet on cam lift hinges with 120 degree stay open feature. Door openings include low voltage, anti-condensate heaters. A plug-in type vinyl magnetic gasket is attached to each door for positive seal. Convenient, contoured, pull handle is made of black anodized aluminum. An 8' cord set is provided with 115 volt models. Interior arrangement includes 2 steel wire epoxy coated shelves behind each door, adjustable in 1/2 inch increments.

Refrigeration:

Forced air refrigeration systems use capillary tube to meter refrigerant. Automatic electric defrost is standard. Unique front venting of air through grilles located below doors permits units to be installed against back walls and even on curbs. Automatic (non-electric) condensate evaporator is provided.



UCF27



UCF48



Made in USA
<http://www.Beverage-Air.com>



BEVERAGE-AIR.
a Specialty Equipment company

PO Box 5932, Spartanburg, SC 29304
1-800-845-9800 Fax No. 1-864-582-5083

Model Specified _____ Store# _____

Location _____ Quantity _____

BEVERAGE-AIR®

Standard Undercounter Freezer Cabinets

Models: UCF27 / UCF48

MODEL	UCF27	UCF48
DIMENSIONAL DATA		
Net Capacity (cubic ft.)	6.2	11.8
Net Capacity (liters)	175	334
Width overall (inches)	27"	48"
Width overall (mm)	685	1219
Depth overall (inches) - Less handle	29 ⁵ / ₈ "	29 ⁵ / ₈ "
Depth overall (mm) - Less handle	753	753
Height overall on 6" casters	34 ¹ / ₂ "	34 ¹ / ₂ "
Height overall (mm) on 6" casters	876	876
Depth with Door Open 90°	53 ³ / ₈ "	50 ³ / ₈ "
Clear Door Opening	22 ¹ / ₂ " x 21 ¹ / ₂ "	19 ¹ / ₂ " x 21 ¹ / ₂ "
Number of Shelves	2	4
Number of doors	1	2
ELECTRICAL DATA		
Volts	115	115
Full load amperes 115/60/1	6.0	7.0
REFRIG. DATA		
Refrigerant	404A	404A
Horsepower	1/4	1/3
WEIGHT DATA		
Gross Weight (Crated lbs)	162	239
Gross Weight (Crated kg)	73.5	106

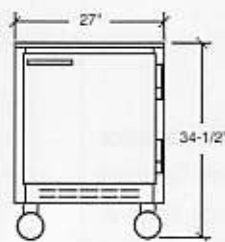

UCF-27 Front

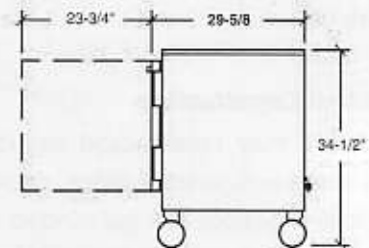

UCF-27 End

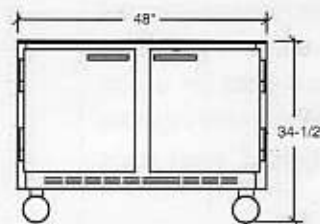

UCF-48 Front

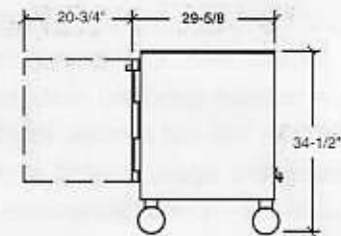

UCF-48 End



Available From:



BEVERAGE-AIR®

a Specialty Equipment company

PO Box 5932 • Spartanburg, SC • 29304 • USA

1-800-845-9800 • Fax No. 1-864-582-5083

www.Beverage-Air.com